

# Adfresco® Café Barrier

Patent No. GB 2472843

The ultimate in quality and design



- Unique **patented design**
- **Highest quality** 3-series **stainless steel** throughout – excellent outdoor performance and high chip/scratch resistance
- **Quick and easy** to assemble – simple pictorial instructions and Allen keys provided
- **Fully compliant** with Local Authority and Disability Discrimination Act (DDA) requirements
- Range of banner size and **material options available** (see following page)
- **Flat packed** with sectional **cross rails** for ease of distribution and storage



*Use individually or link together*



**In stock**  
All printed banners  
are made to order



**Recyclable**  
Stainless steel cross rails, poles and bases.  
Designed for easy 'end of life' recycling.



Cross rails with easy 'clip-in' attachment – intuitive quick-release operation



Rigid lower cross rails ensure audible 'tap' and resistance for the visually impaired (fully DDA compliant)



14.4kg stanchions with 360mm diameter bases for optimum stability.

Durable rubber base edges prevent damage to base/floor and give option to 'roll' rather than lift.



Unique 'smooth glide' sliding ring:

- Improves stability by allowing banner to flex in the wind
- Aids banner/cross rail installation and removal
- Keeps banner flat
- Eliminates rattling and pole damage associated with metal variants

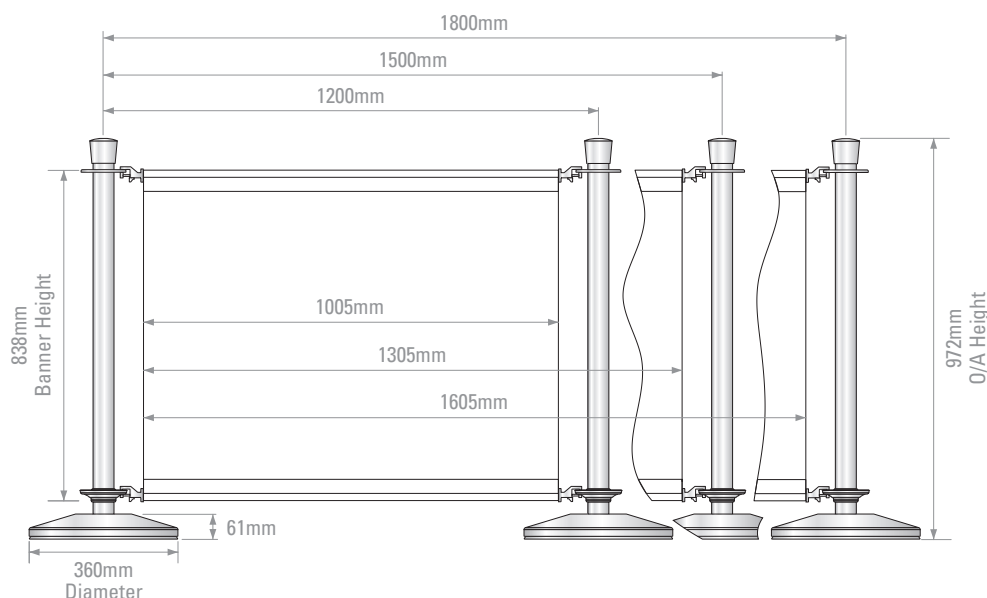

Chrome plated 'Eye Plate' available for wall mounting

Specification			
Item	Dimensions (mm)	Weight (kg)	Order Code
Pole	O/A height: 972 Diameter: 51	0.9	CBBPOLER
Sliding ring	110 (dia.) x 30 (h)	0.3	CBBRING
Base	Height: 61 Diameter: 360	13.5	CBBBASE
Cross Rail (2 per banner required)	Length: 1200*	0.8	CBCR1200
	Length: 1500*	1.3	CBCR1500
	Length: 1800*	1.4	CBCR1800
Banner	1005 x 838	—	Please call for details
	1305 x 838		
	1605 x 838		
Eye Plate (for wall mounting)	40 x 40 x 35 (w x h x d)	0.06	CBBEYERING

\*Refers to distance between centres of poles.

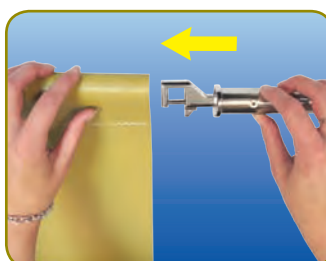

Quick and easy to use – simply slide cross rail into banner hem and roll-up for storage

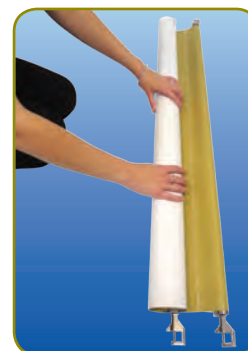

## Printed banners available in a choice of materials:

### Light Block PVC

Reinforced and totally opaque, this is perfect for double-sided print, long outdoor life and vibrant colour reproduction. The easy 'wipe clean' surface makes it ideal for front-of-house food and drink environments.

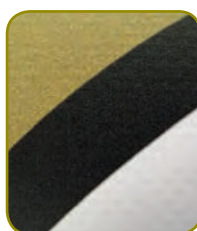

### Front-Lit PVC

This material has a woven textured surface and canvas appearance, providing a high quality print surface on one side with white or single colour on the reverse. Unlike cotton-based canvasses, it is cost-effective, will never stain, fray or rot, and delivers vivid colour reproduction across the full spectrum.



### Mesh PVC

Provides a semi-transparent finish and allows some air to pass through, making it ideal for windy locations, 'subtle branding' and creating a 'style-bar' look. Full colour print is available on one side with white or single colour on the reverse.



### Polyester Canvas

A traditional woven canvas fabric with a dense construction and natural white colour for excellent colour reproduction. This 100% polyester material offers full colour print on one side, with white or single colour on the reverse.



**All our banners are suitable for outdoor use**

# Pole & Rope Barrier

Featuring our high quality Adfresco® poles and bases combined with a choice of rope styles and colours



**Velvet Rope** (above) and  
**Twisted Rope** (below)  
Available in 3 stock colours



- **Highest quality** 3-series **stainless steel** throughout with high chip/scratch resistance
- **Quick and easy** to assemble – simple pictorial instructions and Allen keys provided
- Ropes feature easy 'clip-in' attachment – intuitive quick-release operation
- 14.4kg **stanchions** with 360mm diameter **bases** for optimum stability
- Durable rubber base edges prevent damage to base/floor and give option to 'roll' rather than lift
- Flat packed for ease of distribution and storage



**In stock**



## Recyclable

Stainless steel poles and bases.  
Designed for easy 'end of life' recycling.

## Polished brass and polished black finishes also available

Minimum Order Quantities

Poles/Bases: 100

Ropes: 100

(Extended lead times apply)



14.4kg stanchions with  
360mm diameter bases for  
optimum stability



Ropes feature quick and  
easy 'clip-in' attachment



Chrome plated 'Eye Plate'  
available for wall mounting

Specification				
Item	Colour/Finish	Dimensions (mm)	Weight (kg)	Order Code
Pole	Polished stainless steel	O/A height: 972 Diameter: 51	14.4 (pole: 0.9; base: 13.5)	CBBPOLER
Base		Height: 61 Diameter: 360		CBBBASE
Velvet Rope (with foam core and chrome end clips)	Red	Length: 1500 Diameter: 35	0.6	CBBVROPERED
	Black			CBBVROPEBLACK
	Blue			CBBVROPEBLUE
Twisted Rope (cotton/polyester with weighted core and chrome end clips)	Red	Length: 1500 Diameter: 30	0.6	CBBTROPERED
	Black			CBBTROPEBLACK
	Blue			CBBTROPEBLUE
Eye Plate (for wall mounting)	Chrome	40 x 40 x 35 (w x h x d)	0.06	CBBEYERING

These ropes are designed for a long, maintenance free life indoors. Outdoor use in sunlight or rain will cause the rope colour to fade and reduce the life of the product.